

Universal Power Chair Lift - Outside Style *Installation Guide & Owners Manual*

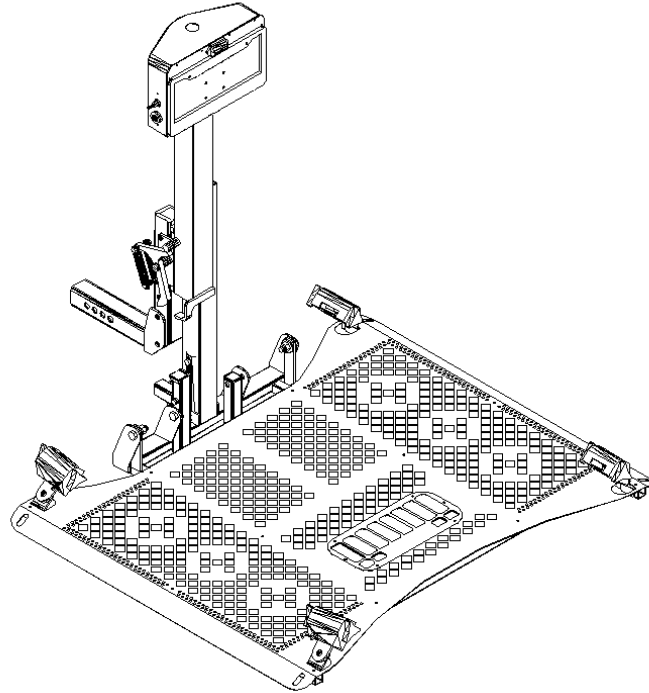

Congratulations on your new lift purchase. The Universal Power Chair Lift is one of the easiest and most trouble free ways to transport your power chair. This manual is written to be used both as an installation guide as well as an operation guide for the end user. **Please read the manual thoroughly BEFORE attempting any installation**, adjustment or use of the lift.

Both installers and operators should familiarize themselves with this entire manual.

The manual will be divided into the following sections for easy reference;

- Section 1 - Unpacking the Lift
- Section 2 - Vehicle Preparation
- Section 3 - Wiring the Vehicle
- Section 4 - Installing the Lift (No Swing Away)
- Section 5A - Preparing the Power Chair
- Section 5 - Installing the Lift with Swing Away Option
- Section 6 - Operating the Lift
- Section 7 - Safety & Maintenance

If you have any questions or comments concerning the installation or operation of your scooter lift, please contact your local distributor for additional technical information. Only authorized dealers should install this lift.

Section 1 - Unpacking the Lift

Your Universal Scooter Lift was factory pre-assembled to require little assembly before installation.

Box contents should include:

Package Check List

- Main lift body (# 1)
- Hitch Post (# 2)
- Hitch Adapter (# 3)

Hardware Package

- Contents include:
- Vehicle Wiring Harness (# 5)
 - Required Fasteners
 - Keys
 - Black tie wraps

FIGURE 1

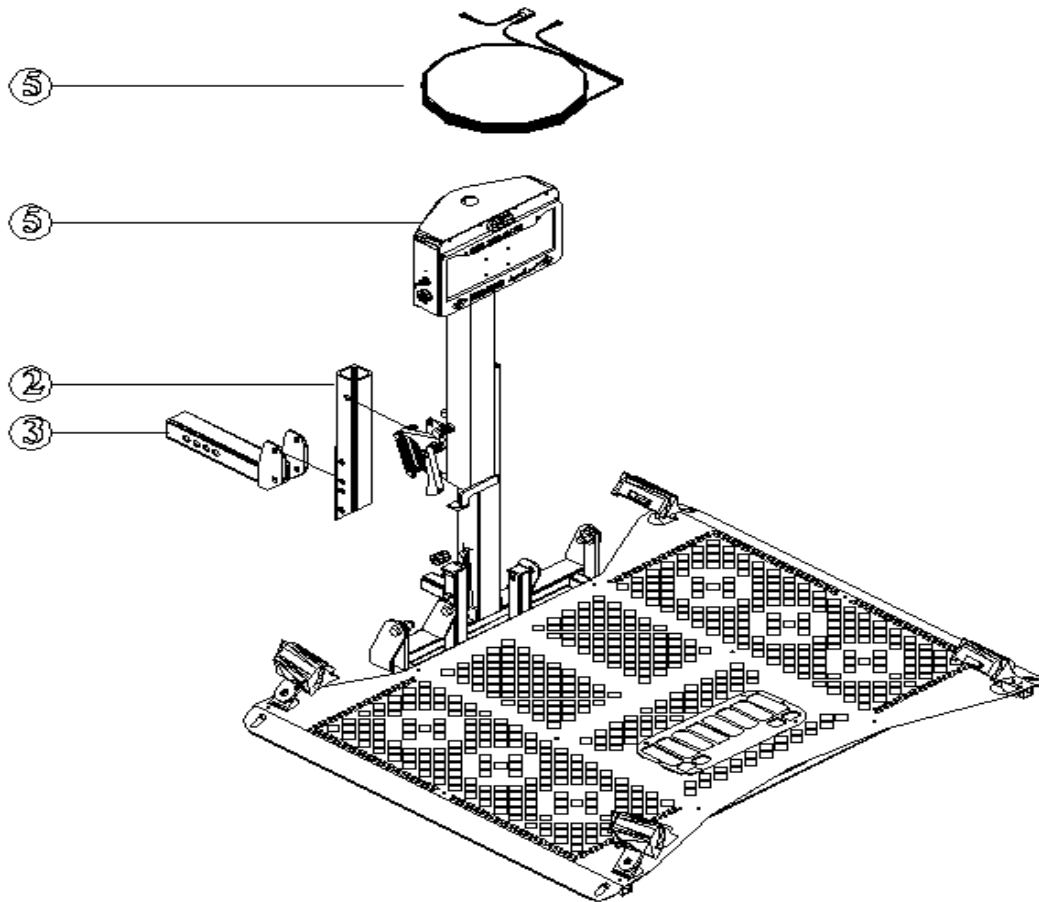

Each lift is packaged to be used with a standard Class III hitch. If a Class II hitch or Swing Away option is required, separate packages will be used for the additional parts. See Section 5 for installing a lift with the Swing Away option in this manual.

Be sure and check the contents of the box against the package check list to be sure that all parts are included with the lift that are required for proper installation. If any parts are missing or if any damage is noted, immediately contact the distributor from which you purchased your lift. DO NOT attempt to install or use the lift with any missing or damaged parts.

Section 2 - Vehicle Preparation

To install a Universal Power Chair Lift on a vehicle, it must be capable of accepting a Class III or Class II hitch. If you are unsure about the hitch required, there are different places for you to check.

Hitch Shops - Check your local area for shops that specialize in trailer hitches. They will normally have in stock the hitch that would be required for use with the lift.

Internet - Some web sites list the compatibility of hitches with vehicles. These include the following;

www.hitch-web.com,
www.reeseprod.com, or
www.draw-tite.com

These sites have areas where you can enter your vehicle information and it will list the types of hitches available to be installed. Remember, not every vehicle is capable of having a hitch installed. Each type of hitch is capable of bearing a different amount of tongue weight. Remember that you must add the weight of the lift to the weight of the power chair that you are purchasing and make sure that the total weight does not exceed the recommended tongue weight of the hitch. The Power Chair Lift weighs 79 lbs. Add 50 lbs. when using a swing away.

Your Universal Power Chair Lift is equipped with a license plate holder and light. If possible, have the installer of your hitch run a standard 4 post trailer light harness to the hitch area. This will allow you to simply plug the license plate light wiring into the trailer plug with no additional wiring required at the time of lift installation.

IMPORTANT NOTE: A trailer light wiring plug is good only for the license plate light and not to power your lift. All lifts must be wired directly to the positive pole of the battery using the wiring harness supplied with the lift. Any attempt to wire the lift into ANY secondary harness will cause the lift to run poorly and possibly damage the motor. The trailer light wiring simply does not carry the proper current to power the lifting motor.

- **IMPORTANT NOTE: The receiver tube on the hitch must be installed so that it is parallel to the ground. This is not a recommendation, but rather a requirement.** If the hitch is not installed properly, it may affect the working of the lift.
- Some vehicles will require that the rear suspension be supplemented by the addition of air adjustable shocks, air bags in the springs or other devices to keep the vehicle level.
- Because receiver tubes on Class II and Class III hitches have a wide variance of tolerance, it may be necessary to reduce the movement of the lift in the receiver tube by installing a pinch bolt as shown below. This would reduce any rattle caused by the movement of the Hitch Adapter in the receiver.

FIGURE 2

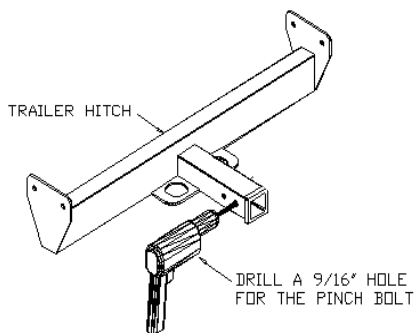
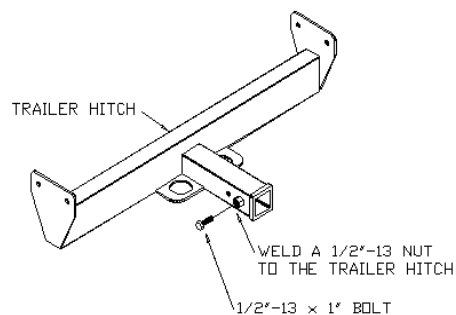

FIGURE 3



- A vehicle with a Class III (Class II requires optional accessories) hitch and standard 4 post trailer wiring is ready for installation of the lift.

Section 3 - Wiring the Vehicle

IMPROPER WIRING IS THE #1 CAUSE OF PROBLEMS IN THE OPERATION OF A VEHICLE LIFT. PLEASE FOLLOW THE WIRING INSTRUCTIONS CAREFULLY

Located in the hardware package of your lift is the vehicle wiring harness for the lift to be installed. The harness is designed to run under the vehicle that the lift is being installed on. Unwind the harness and lay it flat. One end has a plug that both the red and black wires attach to. This is the lift end of the harness and goes to the back of the vehicle. The black wire will be a ground that attaches to the frame of the vehicle. The red wire will run under the vehicle and attach to the positive post on the vehicle battery.

- Start at the rear of the vehicle and tie the plug about even with the end of the hitch receiver tube. Run the red wire under the vehicle and up to the engine compartment to the battery. The red wire is approximately 23 ft. long and should accommodate most vehicles. In fact, at times you will have excess wire when you reach the battery. In this case, determine the proper length to reach the battery and mark the wire. **(Remember to leave enough wire to allow the attachment on the underside of the vehicle)**. It is recommended to attach the wiring to the vehicle before cutting the wire.
- After making sure that the plug in the back is in the proper place, go back to the red wire at the battery and remove the circuit breaker from the end of the red wire by unplugging the connector at the breaker. Cut and strip the red wire at the predetermined mark and attach a new insulated connector that is located in the hardware package. Reconnect the circuit breaker to the red wire and attach the short red wire with the terminal end to the positive post on the battery.

• **IT IS IMPORTANT THAT THE RED WIRE BE RUN DIRECTLY TO THE BATTERY OF THE VEHICLE.** Failure to wire the lift directly to the battery will cause the lift not to work properly and possibly cause damage to the lift!! Any attempt to run the power from a secondary wiring harness in the vehicle will not supply the proper power to the lift.

- Once wiring is attached to the vehicle, use the black plastic ties to secure the wire to the vehicle. **CAUTION! Route the harness away from the exhaust system, brake lines, fuel lines and sharp edges.**
- Once the red wire is in place, you will need to install the ground wire to the **frame of the vehicle**.

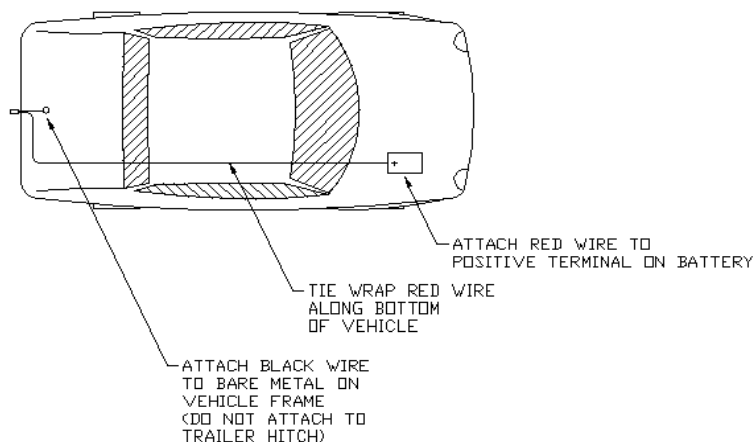

FIGURE 4

IMPORTANT!! The ground must be run to the VEHICLE FRAME ONLY!! If you ground the lift to any other source the motor will not ground properly and it will cause it to operate at less than the desired capacity. **DO NOT GROUND THE LIFT TO THE HITCH OR THE FRAME OF THE LIFT!!** The only proper place to ground the black wire is to the frame of the vehicle.

In many instances, there will be a bolt on the frame that you can use. If not, you may be required to drill a hole and bolt or screw the wire to the frame. **It is also important to remove any dirt, paint or undercoating from the area that you are grounding to.** Prep the area using a small piece of sand paper. The ground needs to be touching **BARE METAL** on the frame.

It can not be stressed enough that the wiring of the lift be done exactly as described above. Any warranty claim will not be covered if it is determined that the lift was not wired to the battery or grounded properly.

Section 4 - Installing the Lift (no Swing Away option)

Your lift will come shipped to you factory pre-assembled.

- To prepare the lift for installation you must attach the lift to the Hitch Post and Hitch Adapter that are shipped with the lift (See parts list in section 1). The proper attachment place is determined by the height of the installed hitch on the vehicle.
- Measure from the bottom of the hitch to the ground. Use Figure 6 below to determine which set of holes to use when setting up the Hitch Post and Hitch Adapter. (See figure #5) Use the 1/2" x 3-1/2" bolts and nuts provided and tighten.

FIGURE 5

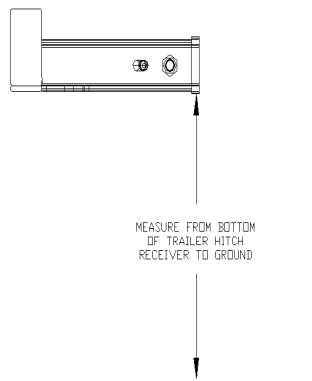
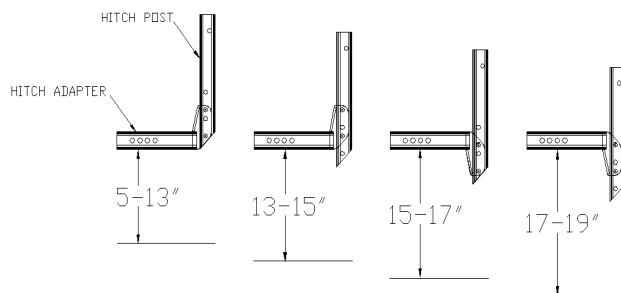

FIGURE 6



- Once you have determined the proper adjustment for the Hitch Post and have attached it to the Hitch Adapter, insert the adapter into the hitch receiver and attach it using the 1/2" x 3-1/2" bolt, (2) washers and lock nut.
NOTE: If a Class II hitch is used, the Hitch Adapter must be replaced with a Class II Hitch Adapter—Part #AL136.
- Move the folded lift to the rear of the vehicle with the motor box folded away from the vehicle. With assistance, carefully lift the unit up to the Hitch Post and attach it using the 1/2" bolt and lock nut provided. **DO NOT OVERTIGHTEN THIS BOLT!** It is a pivot point!

HINT!!!! Once the lift is placed behind the vehicle, plug the power cord into the harness that you have installed on the vehicle. Turn the key on and use the toggle **DOWN** switch to raise the motor box. Continue to power the lift until the mounting holes in the lift are even with the top hole in the Hitch Post. Attach the lift to the post using the supplied 1/2" bolt with lock nut and washers. Using this method will allow you to attach the lift without physically having to lift the unit and hold it while the bolt is inserted.

- Route the lift power cord down the lift away from its moving parts. The cord should follow along the post and be secured with zip ties provided to allow the lift to operate without disconnecting the power cord.
- Once the lift is secured to the Hitch Post and the bolt is tightened, (**DO NOT OVERTIGHTEN**) use the toggle switch to move the platform to a couple of inches off of the ground. Note that as the platform rises off of the ground, the locking mechanism automatically engages. When the chair is on the platform and it is lifted, the locking mechanism will hook onto the undercarriage of the chair and secure it into place for transport. When the platform is lowered to the ground, the mechanism will automatically unlock from the chair. Make sure the mechanism is operating properly before attempting to load a power chair.

Section 4 - Continued

- Load the power chair on to the platform and secure with the Tensioning Anchor Straps that are located on each corner of the lift. (See Figures #7—#10) Raise the platform to the transporting position. Now lower the platform to the ground. Repeat this several times to make sure all parts are operating properly and the chair is properly secured. Next, remove the power chair from the lift and using the toggle switch, cycle the lift completely up and down to make sure that all parts are in working order and the lift folds up when it is empty.
- When satisfied the lift is in proper working condition, refer to sections 6 and 7 of this manual and review operation with the end user.
- It is the dealer's responsibility to make absolutely sure the chair is properly secured by the locking mechanism. Be sure everything is in proper working order before transporting any power chair.

Figure #7

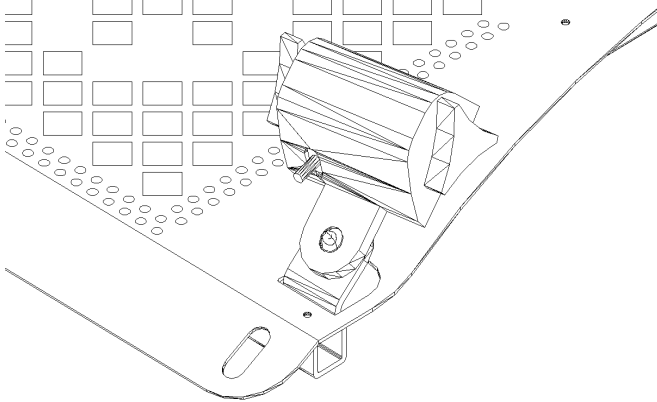

Figure #8

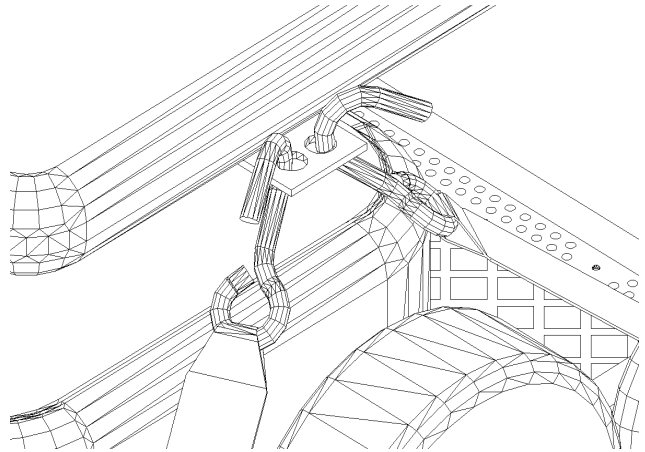
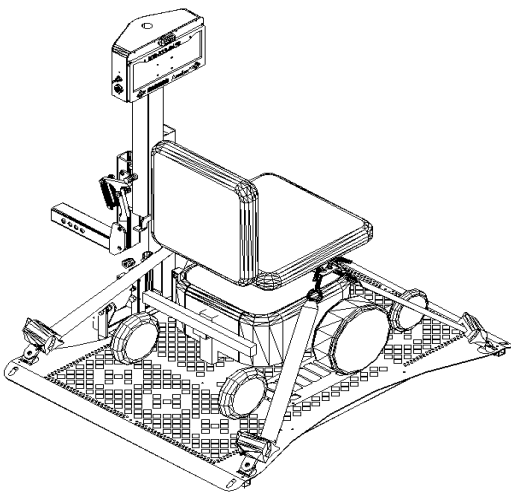

Figure #9



Section 5 A - Preparing the Power Chair for use with the lift

There are 2 options on how to attach the strap hooks to the chair that are included with the lift.

Anchor Plate: The Anchor Plate is a bar that is 20" long and 2 1/2" wide with 2 holes in each end. This plate will work with any chair that has a center seat post that attaches to the bottom of the seat. Attach the Anchor Plate by the following steps.

1. Remove the seat from the chair and turn it over.
2. Loosen the screws that attach the plate to the bottom of the seat. Allow enough room to slide the Anchor Plate between the seat and the seat plate.
3. Center the Anchor Plate in the center of the seat plate with the holes on each end extending evenly on each side of the seat.
4. Retighten the screws that hold the seat plate to the bottom of the seat.
5. Replace the seat on the chair.

The Anchor Plate should extend about 1-1/2" out from the side of the seat cushion. This will allow the user to attach the strap hooks to the Anchor Plate to secure the chair to the lift.

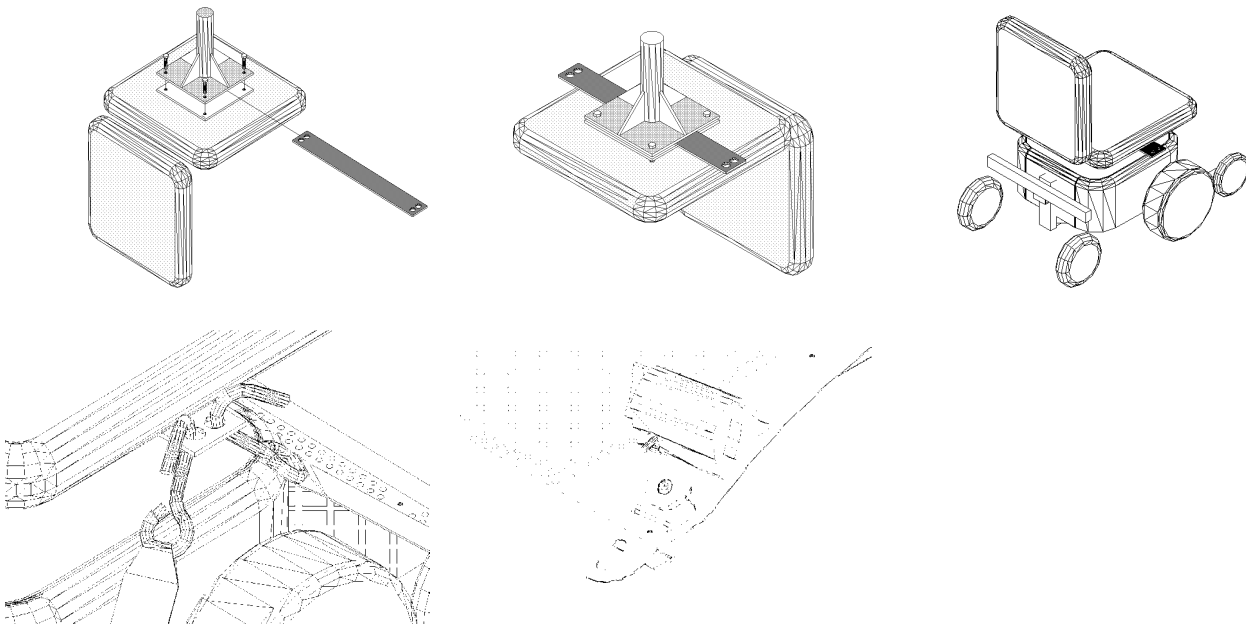

Anchor U-Bolts: The U-Bolts are included to be used with Power Chairs that do not have a center seat post. On this type of chair, the seat is normally attached to a tubular frame. Attach the U-Bolts, one on each side, to the frame as shown below. Make sure that the loop extends to the outside of the chair to allow the strap hooks to be attached by the end user.

Each type of chair will differ slightly and the placement of the U-bolts will differ between different models and manufacturers. Place the Anchor U-Bolts towards the center of the seat if possible. Because of the different types of seats, you may be forced to attach the Anchor U-Bolts more towards the front or rear of the seat., but we recommend attachment as close as possible to the center of the seat. (See Figure below)

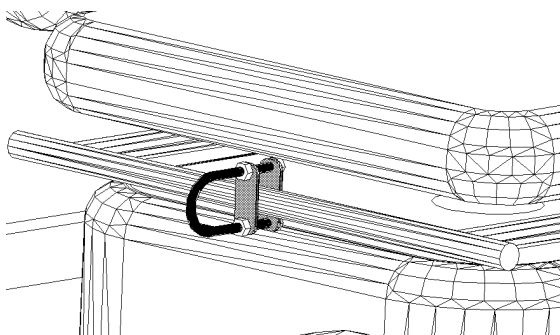

Section 5 - Installing the Lift with Swing Away option

Your lift will come shipped to you mostly pre-assembled.

- To prepare the lift for installation you must attach the lift to the Swing Away and Hitch Adapter. The proper attachment place is determined by the height of the installed hitch on the vehicle.
- Measure from the bottom of the hitch to the ground. Use Figure #6 below to determine which set of holes to use when setting up the Swing Away and Hitch Adapter. Use the 1/2" bolts and lock nuts provided and tighten.

FIGURE 5

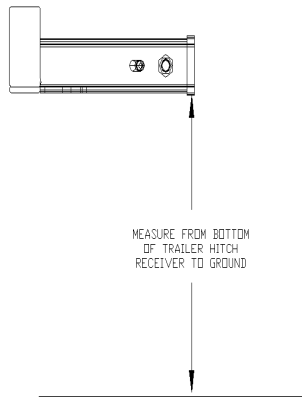
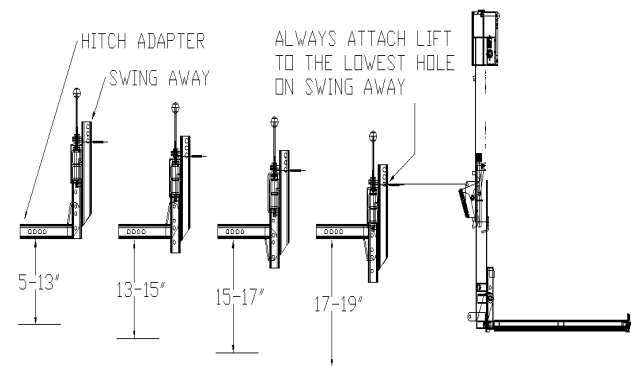

FIGURE 6



- Once you have attached the Swing Away to the Hitch Adapter, insert the Hitch Adapter into the hitch receiver.
NOTE: If a Class II hitch is used, the Hitch Adapter must be replaced with a Class II Hitch Adapter.

CAUTION! Never modify the Hitch Adapter in any way! This includes adding or removing material and drilling any extra holes.

- At this point, attach the lift to the Swing Away. Move the folded lift to the rear of the vehicle with the motor box folded away from the vehicle. With assistance, carefully lift the unit up to the Swing Away and attach it using the 1/2" bolt and lock nut provided. **Do not over tighten as this is a pivot point.**

HINT!!!! Once the lift is placed behind the vehicle, plug the power cord into the harness that you have installed on the vehicle. Turn the key on and use the toggle DOWN switch to raise the motor box. Continue to power the lift until the mounting holes in the lift are even with the hole in the Swing Away. Attach the lift using the supplied 1/2" bolt with lock nut and washers. Using this method will allow you to attach the lift without physically having to lift the unit and hold it while the bolt is inserted.

- Route the lift power cord down the lift away from its moving parts. The cord should follow along the Swing Away arms secured with zip ties provided to allow the arms to open without disconnecting the power cord.

IMPORTANT!! NEVER OPERATE THE SWING AWAY WITH THE SCOOTER ON THE LIFT!! This will cause damage to the lift and potentially cause damage to the vehicle and the scooter!!

CAUTION!! If the bracket that locks the swing away closed is not tight when the lever is in the closed position DO NOT use the lift until it has been properly adjusted using the nut on the bottom of the clamp. See Figure #11.

Section 5 - continued

- Load the power chair on to the platform and secure with the Tensioning Anchor Straps that are located on each corner of the lift. Raise the platform to the transporting position. Now lower the platform to the ground. Repeat this several times to make sure all parts are operating properly and the chair is properly secured. Next, remove the power chair from the lift and using the toggle switch, cycle the lift completely up and down to make sure that all parts are in working order and the lift folds up when it is empty.
- Once the lift is properly adjusted, lower the platform to the ground and raise it back to the transporting position. Repeat this several times to make sure all parts are operating properly and that the power chair is properly secured. Next, remove the power chair from the lift and using the toggle switch, cycle the lift completely up and down to make sure that all parts are in working order and the lift folds up when it is empty.
- When satisfied the lift is in proper working condition, refer to sections 6 and 7 of this manual and review operation with the end user.
- It is the dealer's responsibility to make absolutely sure the chair is properly secured by the locking mechanism. Be sure everything is in proper working order before transporting any power chair.

FIGURE 10

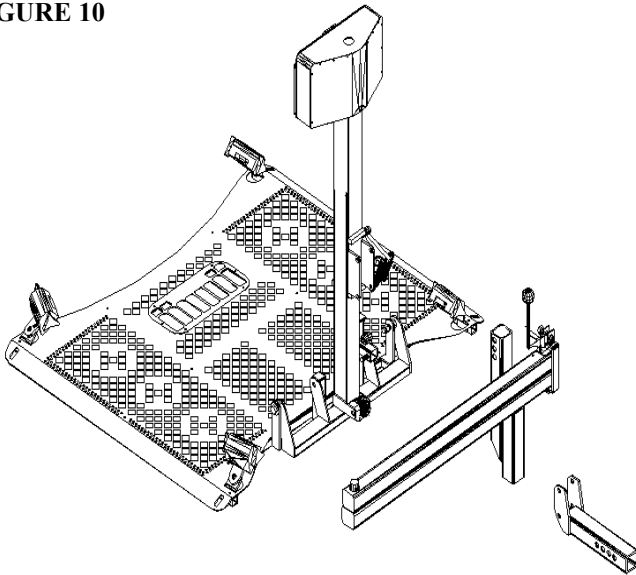
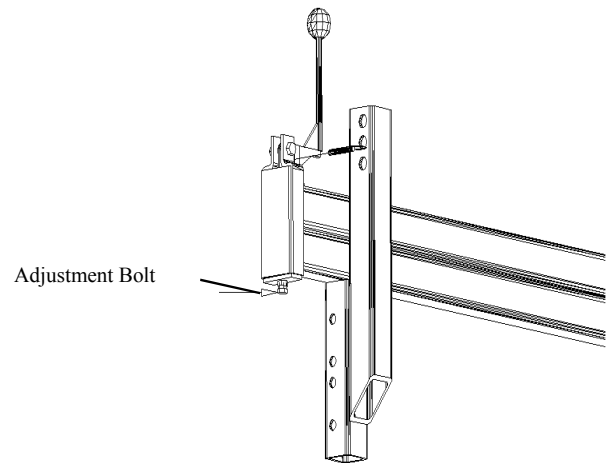

FIGURE 11



Section 6 - Operating the Lift

LOADING YOUR POWER CHAIR ON THE LIFT

Turn ON the power switch with the key furnished with your lift. Lower the platform using the UP/DOWN toggle switch. Pushing the switch downward will cause the platform to lower. The platform will first unfold to the horizontal position, then continue lowering to the ground. Release the UP/DOWN switch just as the platform reaches the ground; do not attempt to raise the rear of the vehicle with the lift or damage could be done to your lift or vehicle.

CAUTION: Keep your feet out from under the platform as it lowers.

Once the lift platform is on the ground, drive your power chair onto the platform as close to the center of the platform as you can get. Make sure that all the chair's wheels are completely on the platform surface. Take the hook that is located on the anchor strap located on the corner of the platform and attach it as shown in Figure 7, 8 and 9 by pressing the lever on the back of the housing to release the tension on the strap hook. Continuing to press the lever, extend the hook and attach the hook to the Anchor Plate that is installed on the chair. Re-press the lever located on the back of the housing to take up any slack that is in the strap. Repeat this for all four corners. After all four hooks are attached, turn the knob on the anchor strap housing to double check the tension on the straps. Using the toggle switch, raise the platform and chair completely up until it stops.

Your power chair is now ready for travel. You may wish to remove your key from the power switch to avoid any potential tampering with your lift and scooter.

Caution: Before driving off with your power chair on the lift, make sure that the chair is firmly held down on the platform by turning the tensioning handles on the side of the strap base.

Caution: When driving with your chair on the lift, slow down for pot holes, speed bumps, railroad tracks, etc. Your lift could be damaged by abuse if subjected to excessive loads imposed by rough driving.

Caution: Do not enter steep driveways straight on. Enter and leave at an angle to the street so that you lift platform does not drag on the ground.

Caution: Do not attempt to move the vehicle with the lift platform in the down position. If moved this way, the lifting mechanism will be damaged.

UNLOADING YOUR POWER CHAIR:

To unload your power chair, just turn ON the power switch and push the UP/DOWN toggle switch to the down position. Hold the switch down until the platform just touches and is level to the ground. Press the red release button on the Strap Retractor to release the tension and unhook the strap from the chair. Continuing to press the button, allow the strap to retract until the hook reaches the housing. Repeat this step on each corner until all four straps are released.

Drive your power chair off the lift platform. When the power chair is clear of the platform, raise the platform by pushing up on the UP/DOWN switch.

To park your lift in the stowed position, hold the UP switch. The platform will start up in the horizontal position. During its travel upward, the platform will fold up into the stowed or vertical position. Hold the switch until the platform travel stops automatically.

You may wish to remove you key from the power switch to avoid any tampering with your lift.

Special Note: The lift features a manual override. If the vehicle or lift loses power, simply remove the round plastic cap from the top of the motor box and using a 3/8" socket, turn the wrench clockwise to raise the lift and counter clockwise to lower the lift. (If the lift does not operate properly, immediately take it to the local dealer. DO NOT attempt to modify the lift in any way!)

Do not attempt to move the vehicle without the lift in the stowed or travel position. Any attempt to move the vehicle without the lift fully up may cause damage to the lift, scooter or vehicle.

Section 6 - Operating the Lift (Swing Away Option)

Many power chair owners require access to the rear of a vehicle. To accomplish this a Swing Away option is added to the lift installation. This allows the complete lift to be conveniently and easily swung away from the back of the vehicle and allow easy access to the trunk or lift gate. The Swing Away option can be purchased from any authorized dealer and added at any time.

OPENING THE SWING AWAY:

- Unlock the safety clamp by pulling the snap pin chained to the clamp.
- Open the safety clamp by pulling the lever down and away from the lift. This will unlock the Swing Away and allow it to be pulled open.

IMPORTANT!! NEVER OPERATE THE SWING AWAY WITH THE POWER CHAIR ON THE LIFT!! This will cause damage to the lift and potentially cause damage to the vehicle and the power chair!!

CAUTION!! Always insure that the vehicle is on level ground before attempting to open the Swing Away. Failure to do so may result in the operator losing control of the lift causing damage to persons and property.

- Grasp the lift firmly and swing it out away from the vehicle. The Swing Away can be opened up to 180 degrees from the closed position to allow full access to the rear of the vehicle.

CLOSING THE SWING AWAY:

- Grasp the lift firmly and swing it back towards the vehicle into the closed position. This will place the two 2" square horizontal tubes parallel with each other.
- While holding the bracket around the bottom horizontal tube, push the safety clamp up and towards the lift. This will lock the Swing Away and ready it for travel.
- Insert the snap pin into the safety clamp to lock it into place.

CAUTION!! Always leave the safety pin in the clamp to lock it when the Swing Away is closed.

IMPORTANT NOTE!! If your safety clamp does not SECURELY latch the Swing Away arm in the closed position DO NOT USE THE LIFT until the clamp is adjusted by an authorized dealer. Failure to make the proper adjustment can cause the unit to open when traveling down the road.

FIGURE 10

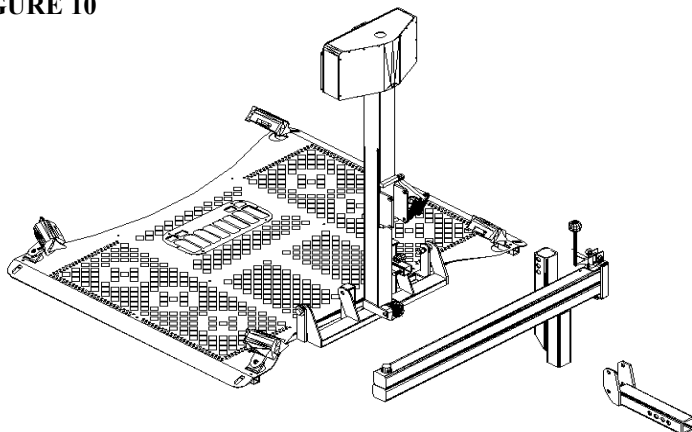
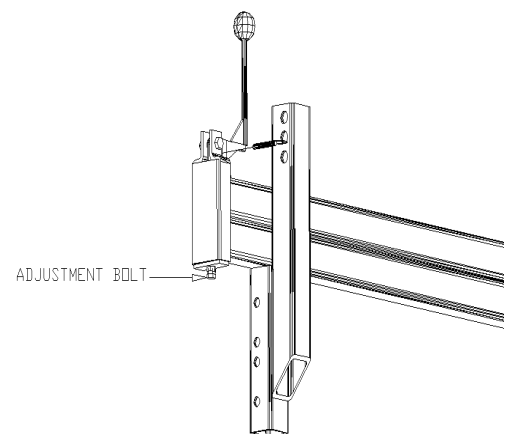

FIGURE 11



Section 7 - Safety & Maintenance

SAFETY:

- Inspect the condition of your lift often. **If any parts are worn or damaged DO NOT USE THE LIFT.** Immediately contact the dealer you purchased the lift from for repairs.
- **Caution:** Keep feet and any other objects out from under the platform as it lowers.
- **Caution:** Some power chairs have pneumatic (air inflated) tires. If your power chair has this type tire, be sure the tires are properly inflated. Improper inflation of the tires will change how the chair fits on the platform and therefore change the amount of clamping force on the power chair. **The power chair can fall off of the lift if not properly secured.**
- **Caution:** Before driving off with your power chair on the lift, make sure that the chair is firmly held down on the platform.
- **Caution:** When driving with your power chair on the lift, slow down for pot holes, speed bumps, railroad tracks, etc. **Your lift could be damaged by abuse if subjected to excessive loads imposed by rough driving.**
- **Caution:** Do not enter steep driveways straight on. Enter and leave at an angle to the street so that your lift platform does not drag on the ground.
- **Caution:** Do not attempt to move the vehicle with the lift platform in the down position. If moved this way, the lifting mechanism will be damaged.
- **WARNING! This lift is not meant for human transport. Power chair must be unoccupied before operating lift.**
- This lift is for power chair transport only. **Do not** attempt to transport any other vehicles or materials on the lift.

MAINTENANCE:

- The Universal Power Chair Lift has been designed to be as trouble free as possible for the owner. The maintenance schedule is no exception.
- Every 30 days oil the pivot points on all moving parts.
- During winter and under dirty and dusty conditions, re-grease the inside square tube every 30 days. Lower the platform to the ground and clean the square shaft with mineral spirits, WD-40 or any good solvent. Once clean, grease the square shaft with a high-grade water-resistant grease, such as boat trailer wheel bearing grease.

NOTE: Your lift was assembled at the factory with Slick 50 "ONE GREASE".

- Check for paint chips and touch up any bare metal with a good gloss black enamel or lacquer to inhibit rust. This may be necessary more frequently when subjected to salt air or road salt.

Warranty:

This lift is covered by a one year factory warranty on materials and workmanship. Contact your local dealer for more information.